

Design R&D Euromobil and Roberto Gobbo

Project

Lab is an open aluminum system, configured with a depth of just 15 cm, designed to accommodate small objects and utensils. Its extensive modularity ensures perfect integration in width and height with all kitchen models. Lab can also be used as a freestanding element.

The black-finished aluminum frame remains a distinctive feature, while the back panel can be customized to contrast or coordinate with the kitchen fronts, creating custom compositions. The system can be equipped with or without integrated lighting, allowing for flexible adaptation to different needs.

Available finishes

- a. TSS
- b. Tecnolamina
- c. Matt eco-lacquered
- d. Matt, super matt, and gloss lacquered
- f. Rovere sabbaiato, Castagno naturale, Eucalipto and Castagno termotrattato, Noce canaletto, Wood liscio
- g. Fenix and Fenix Nta



Examples of modularity

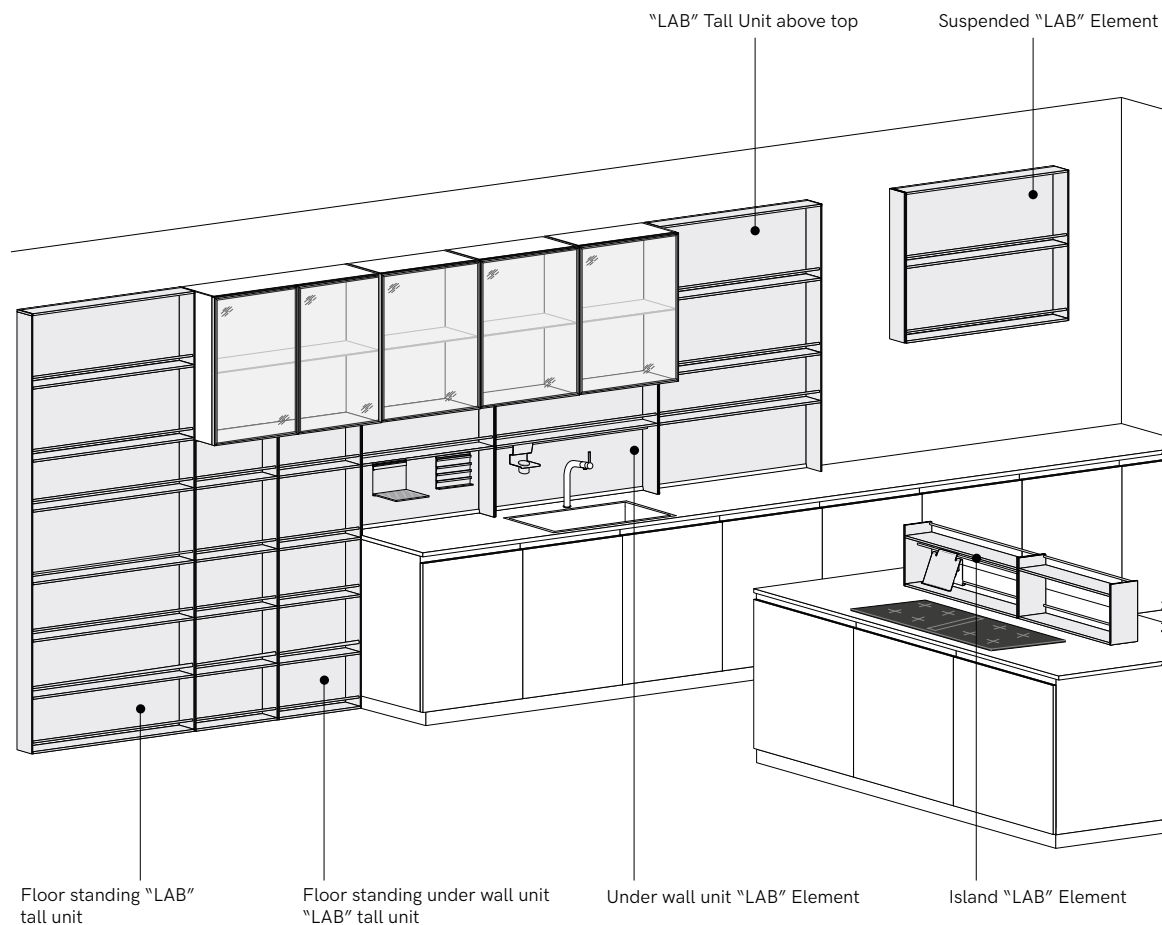

[Find the nearest Euromobil dealer](#) to configure the LAB system according to your needs.